

MS7114

S7114, S7116, S7118,
RACE TO STREET CONVERSION KIT

MBRP®

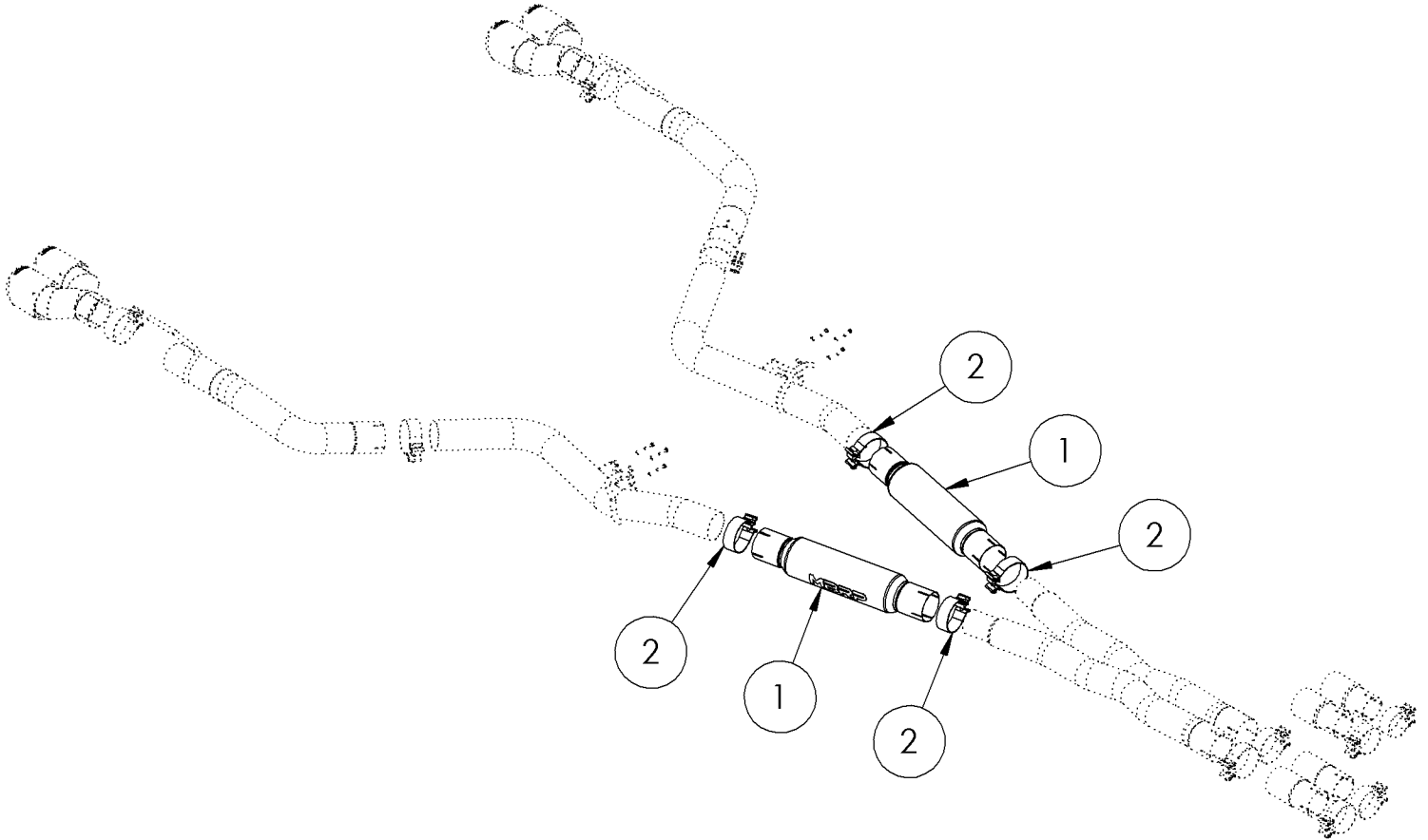

ITEM	DESCRIPTION	QTY
1	RESONATOR	2
2	3.0" CLAMP	4

Refer to this LOT NUMBER when contacting customer service: _____

PLEASE READ BEFORE STARTING INSTALLATION

While MBRP has made every effort to ensure that all components of this system are of superior quality and properly packaged, it is the installer's responsibility to ensure the following before removal of the factory exhaust:

- that ALL components shown above are present.
- that ALL mating components fit together.
- that there are no damaged components.
- that the system you have purchased is appropriate for your vehicle year, model and configuration.
- that the system will not interfere with any modifications previously installed or planned.
- that you have read and understand these instructions.

If you have any questions or are uncertain about any aspect of the installation of this system to your vehicle please contact your dealer before commencing installation.

MBRP

Removal of MBRP Components

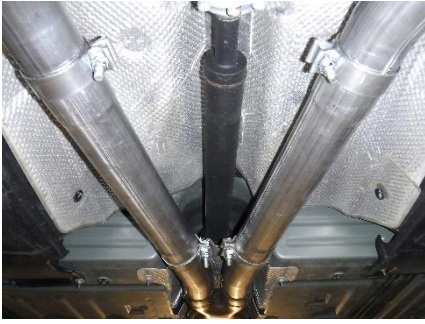

Figure 1

1. Loosen and slide back the four clamps connecting the **Connector Pipes** to the **X-Pipe** and **Under-Axle Pipes**.

Refer to **Figure 1**.

2. Disconnect the exhaust valve actuator wiring located on the **Under-Axle Pipes**, if equipped.

Refer to **Figure 2**.



Figure 2

3. With the exhaust system supported, remove the **Under-Axle Pipe** hangers from the rubber insulators, retaining the insulators for the installation. Alternatively, the factory insulators may be unbolted.

Refer to **Figure 3**.

4. With the **X-Pipe** and **Under-Axle Pipes** supported, carefully remove the two **Connector Pipes** and the four **3.0" Clamps**.

Installation of MBRP Performance Exhaust



Figure 3

1. Place the supplied **3.0" Clamps** onto the outlets of the **X-Pipe** and the inlets of each of the **Under-Axle Pipes**.

2. Using the **Clamps**, loosely install the **Resonators**.

Refer to **Figure 4**.

3. Connect the exhaust valve actuator wiring, if equipped.

4. **Ensure that the alignment of all parts of the system and tips has been maintained.** Align the edge of each band clamp with the edge of the joint it is connecting. Tighten all hardware and clamps, starting at the front and working rearward to secure the system. Check along the full length of the exhaust system to ensure there is adequate clearance for fuel lines, vent lines, brake lines, frame, bodywork, suspension and any wiring, etc. If there is any interference detected, relocate or adjust to provide adequate clearance. Ensure all clamp connections are secure and components are unable to rotate or slide. Band clamps (excluding tip hardware) require approximately 45 lb-ft (60 N-m) of torque. Verify clearances, system security and band clamp torque after 30-60 miles (50-100 km) of driving.

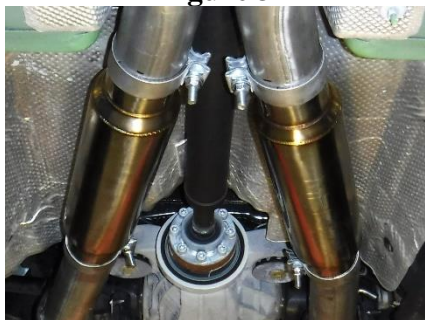

Figure 4

Congratulations! You are ready to begin experiencing the improved power, sound and driving experience of your **MBRP** Performance Exhaust. We know you will enjoy your purchase!